

Express Lane(s) Operational Configuration Options

SIX VARIATIONS OF THE EXPRESS LANE(S) ALTERNATIVE ARE UNDER EVALUATION. THE KEY DIFFERENCES ARE HOW THE RAMPS ARE CONFIGURED NEAR LADY BIRD LAKE.

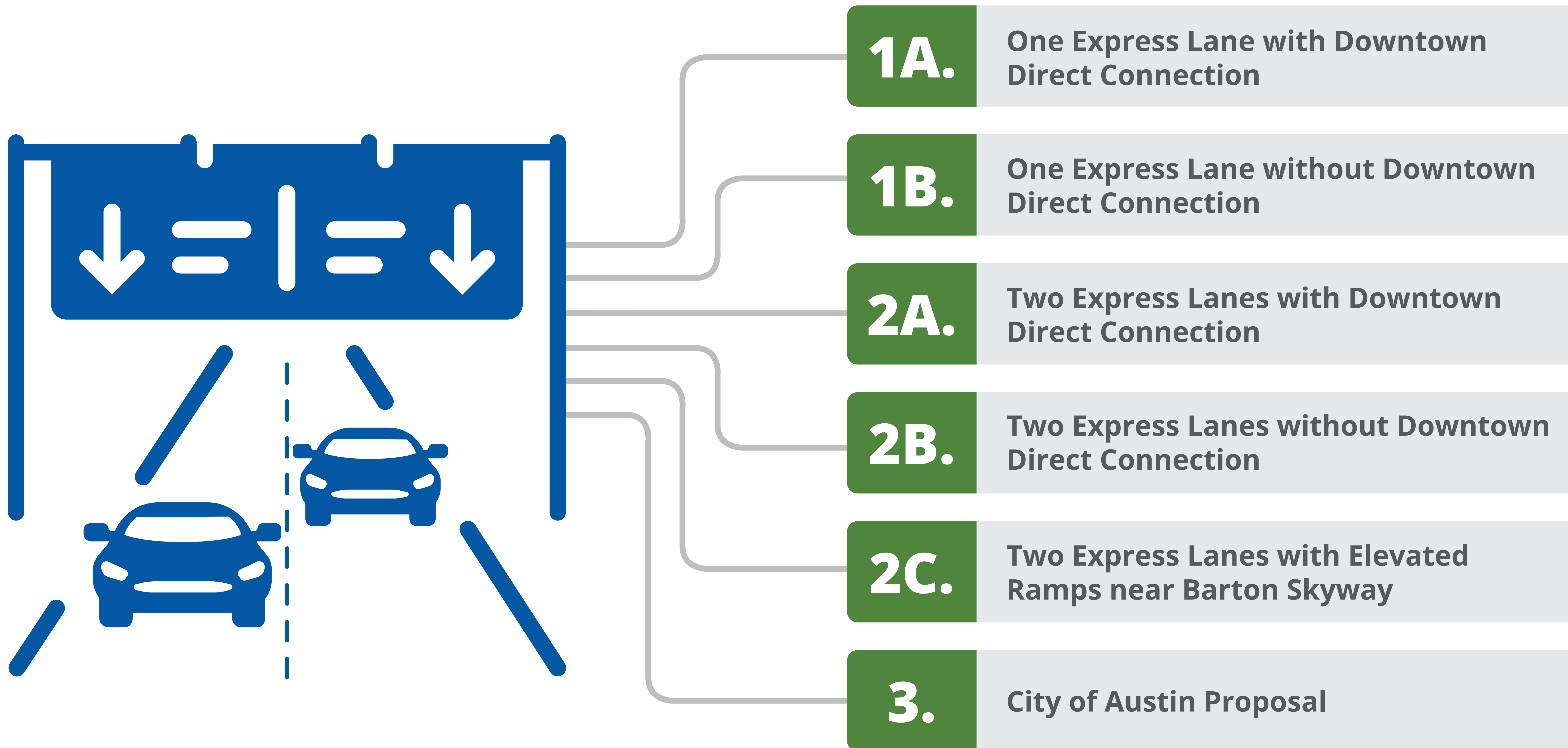



1A: One Express Lane with Downtown Direct Connection

ACCESS TO AND FROM DOWNTOWN: ONE-LANE, ELEVATED DIRECT CONNECT RAMP IN EACH DIRECTION, TO AND FROM CESAR CHAVEZ STREET

LEGEND

Configuration diagram has been simplified for clarity.

- Existing General Purpose lanes
- Proposed Tolloed Express Lane
- Existing Express Lanes
- Proposed Direct Connectors
- Cross Streets
- Express Lane Entrance
- Express Lane Exit
- Connection with Existing Express Lane

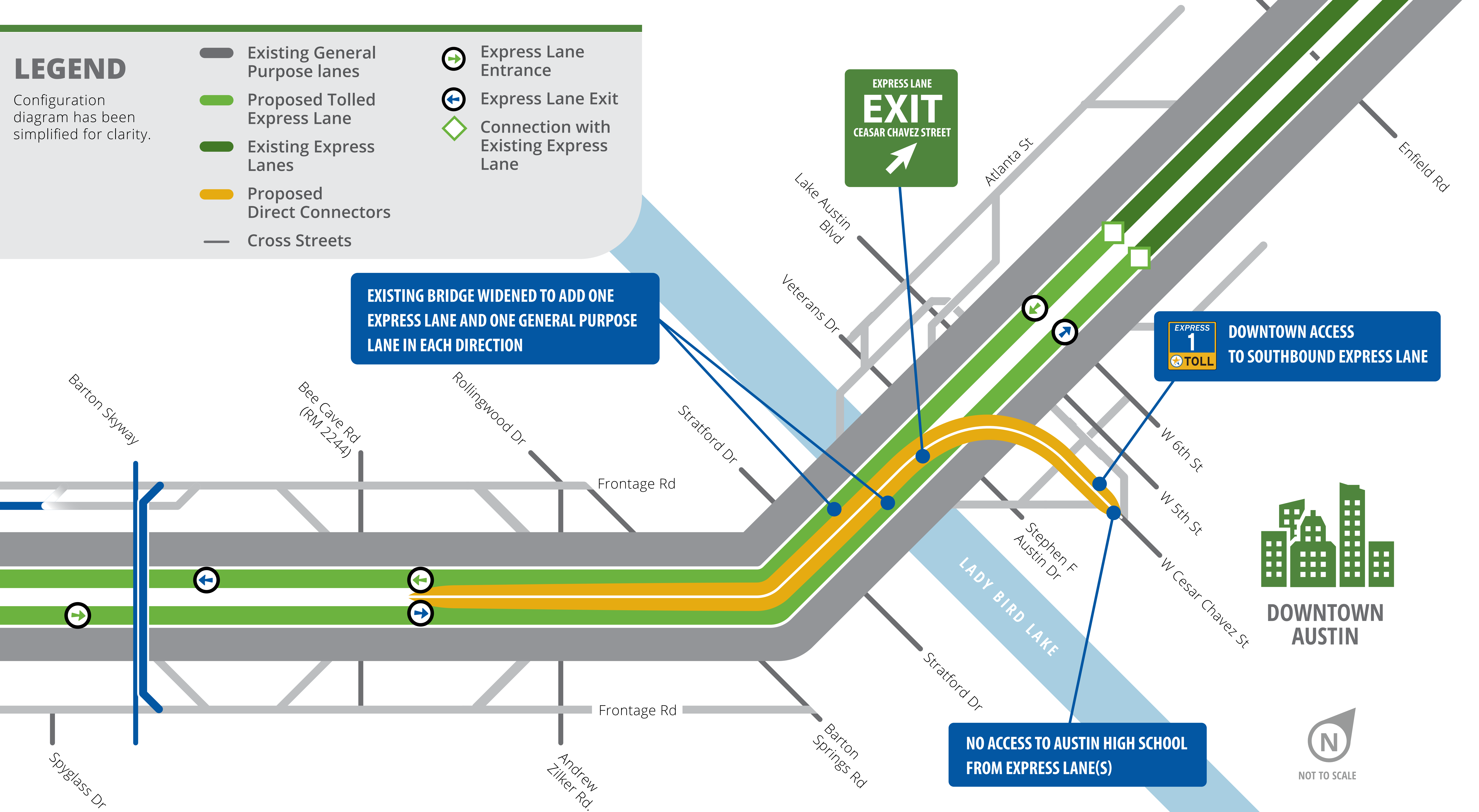

EXISTING BRIDGE WIDENED TO ADD ONE EXPRESS LANE AND ONE GENERAL PURPOSE LANE IN EACH DIRECTION

EXPRESS 1 TOLL DOWNTOWN ACCESS TO SOUTHBOUND EXPRESS LANE

NO ACCESS TO AUSTIN HIGH SCHOOL FROM EXPRESS LANE(S)





MoPac South

1B: One Express Lane without Downtown Direct Connection

ACCESS TO AND FROM DOWNTOWN VIA MERGING ACROSS THREE GENERAL-PURPOSE LANES AND EXISTING RAMPS

LEGEND

Configuration diagram has been simplified for clarity.

- Proposed Tolled Express Lane
- Existing Express Lanes
- Proposed Direct Connectors
- Cross Streets
- Express Lane Entrance
- Express Lane Exit
- Connection with Existing Express Lane

EXISTING BRIDGE WIDENED TO ADD ONE EXPRESS LANE AND ONE GENERAL PURPOSE LANE IN EACH DIRECTION

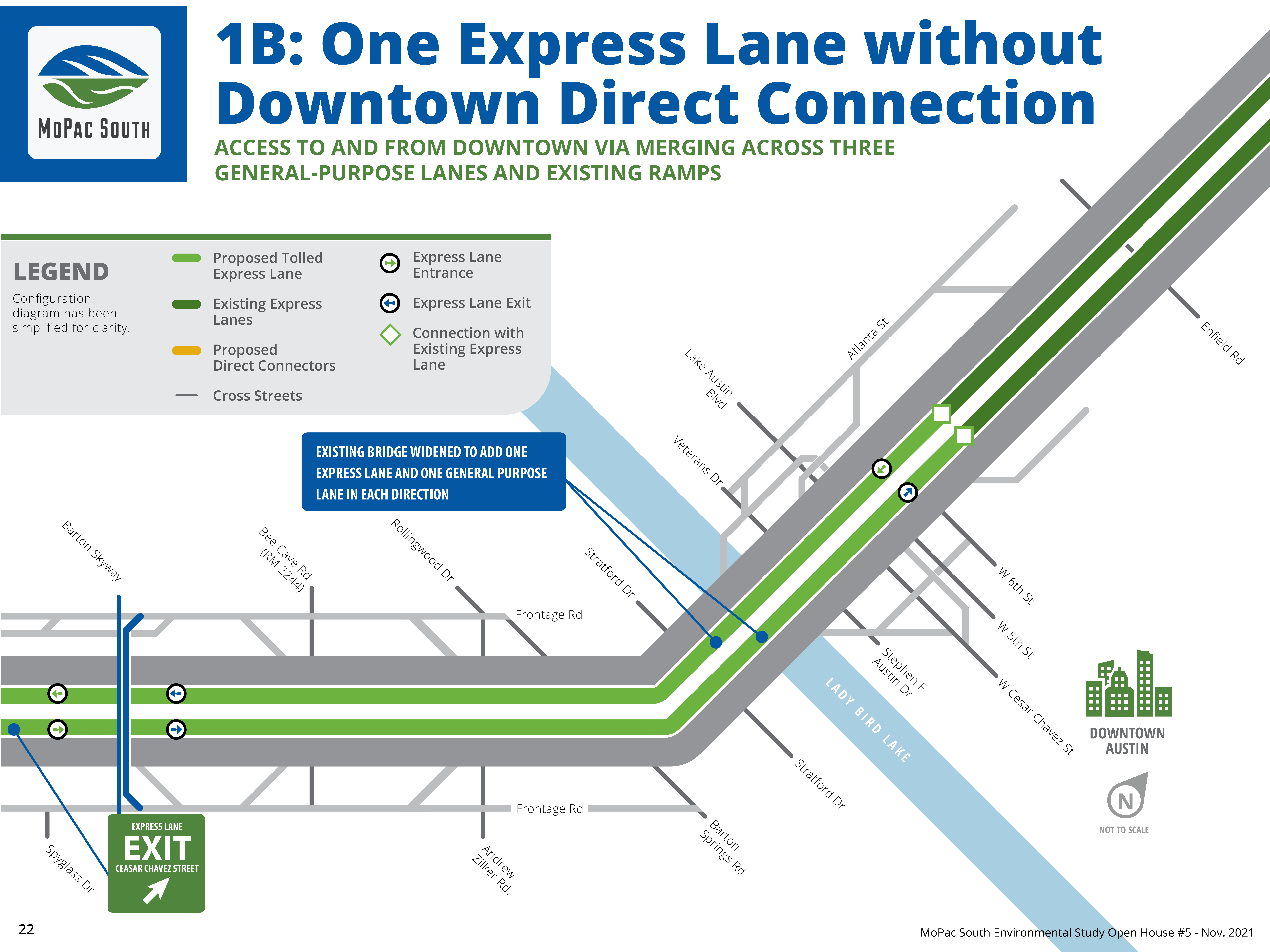

DOWNTOWN AUSTIN



NOT TO SCALE



2A: Two Express Lanes with Downtown Direct Connection

ACCESS TO AND FROM DOWNTOWN: ONE-LANE, ELEVATED DIRECT CONNECTOR RAMP IN EACH DIRECTION, TO AND FROM CESAR CHAVEZ STREET

LEGEND

Configuration diagram has been simplified for clarity.

- Existing General Purpose Lanes
- Proposed Tolloed Express Lanes
- Existing Express Lanes
- Proposed Direct Connectors
- Cross Streets
- Express Lane Entrance
- Express Lane Exit
- Connection with Existing Express Lane

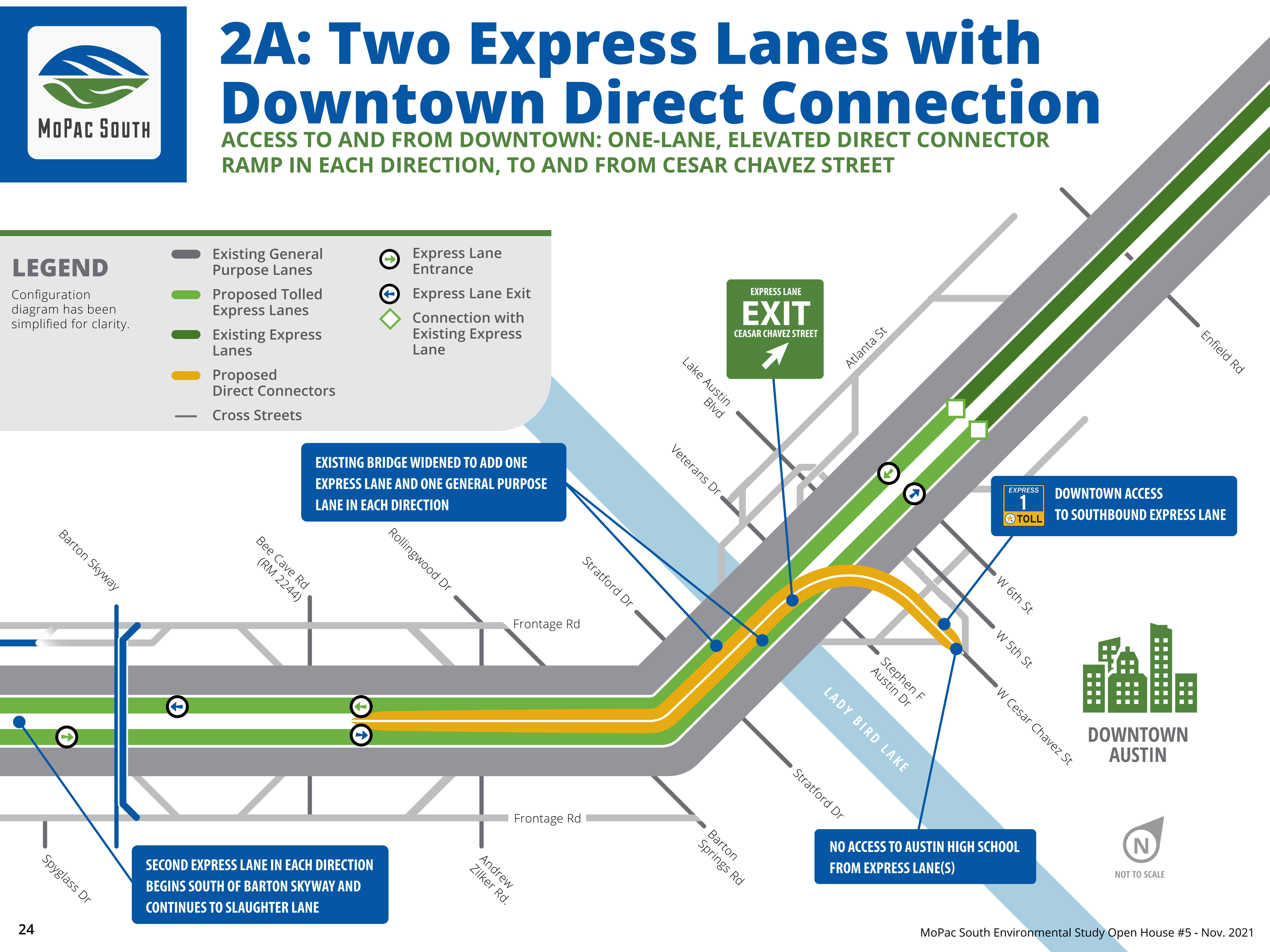

EXISTING BRIDGE WIDENED TO ADD ONE EXPRESS LANE AND ONE GENERAL PURPOSE LANE IN EACH DIRECTION

EXPRESS 1 TOLL DOWNTOWN ACCESS TO SOUTHBOUND EXPRESS LANE

SECOND EXPRESS LANE IN EACH DIRECTION BEGINS SOUTH OF BARTON SKYWAY AND CONTINUES TO SLAUGHTER LANE

NO ACCESS TO AUSTIN HIGH SCHOOL FROM EXPRESS LANE(S)



MoPac South

2B: Two Express Lanes without Downtown Direct Connection

ACCESS TO AND FROM DOWNTOWN VIA MERGING ACROSS THREE GENERAL-PURPOSE LANES AND EXISTING RAMPS

LEGEND

Configuration diagram has been simplified for clarity.

- Proposed Tolled Express Lanes
- Existing Express Lanes
- Proposed Direct Connectors
- Cross Streets
- Express Lane Entrance
- Express Lane Exit
- Connection with Existing Express Lane

SECOND EXPRESS LANE IN EACH DIRECTION BEGINS SOUTH OF BARTON SKYWAY AND CONTINUES TO SLAUGHTER LANE

EXISTING BRIDGE WIDENED TO ADD ONE EXPRESS LANE AND ONE GENERAL PURPOSE LANE IN EACH DIRECTION

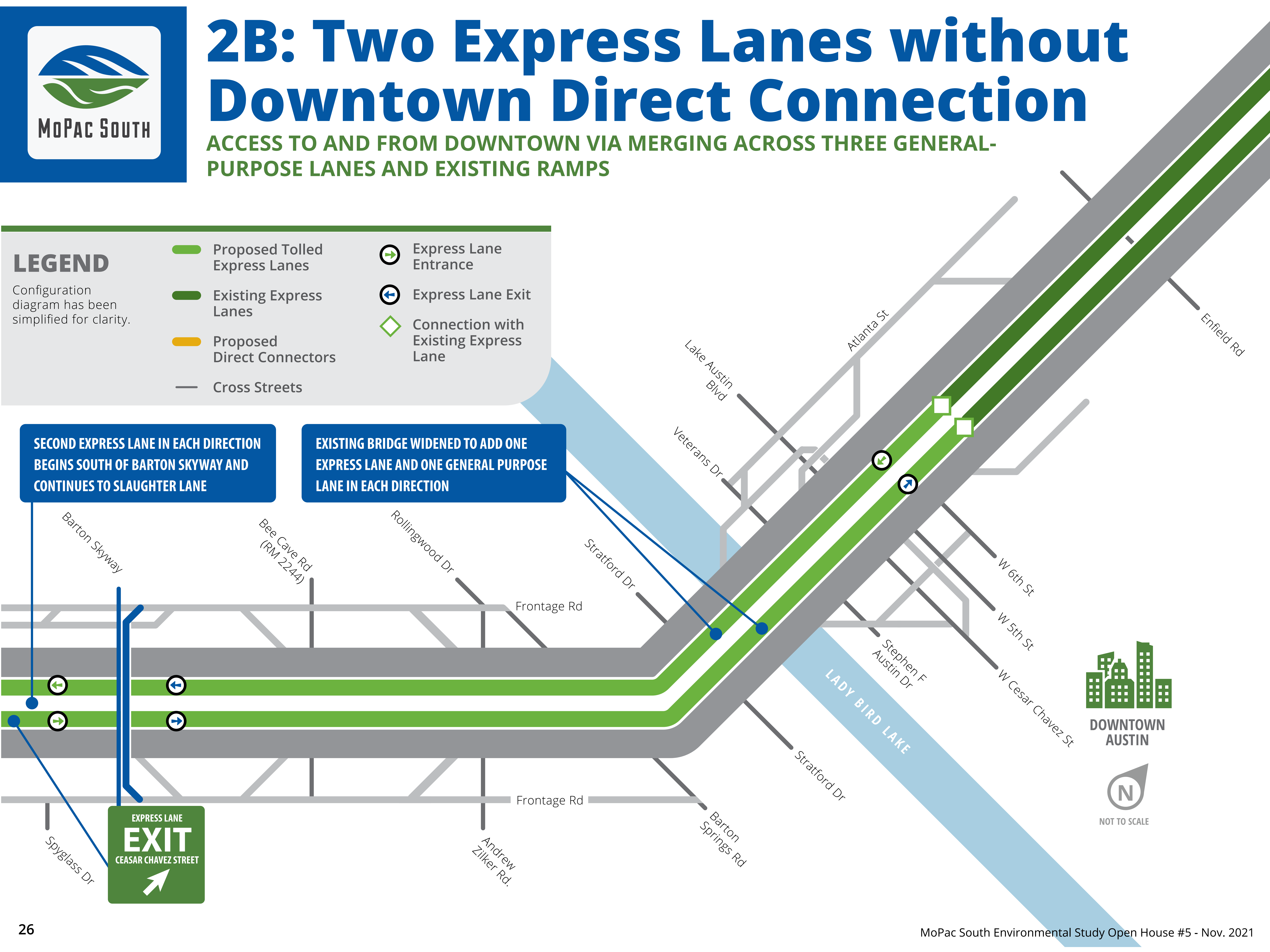

DOWNTOWN AUSTIN

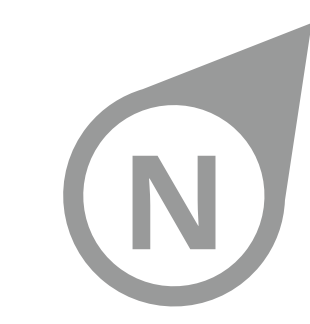

NOT TO SCALE



2C: Two Express Lanes with Elevated Ramps Near Barton Skyway

ACCESS TO AND FROM DOWNTOWN VIA MERGING ACROSS THREE GENERAL-PURPOSE LANES AND EXISTING RAMPS

LEGEND

Configuration diagram has been simplified for clarity.

- Proposed Tolled Express Lanes
- Existing Express Lanes
- Proposed Direct Connectors
- New Roadway and Bridges
- Cross Streets
- Express Lane Entrance
- Express Lane Exit
- Connection with Existing Express Lane

EXISTING BRIDGE WIDENED TO ADD ONE EXPRESS LANE AND ONE GENERAL PURPOSE LANE IN EACH DIRECTION

SECOND EXPRESS LANE IN EACH DIRECTION BEGINS SOUTH OF BARTON SKYWAY AND CONTINUES TO SLAUGHTER LANE

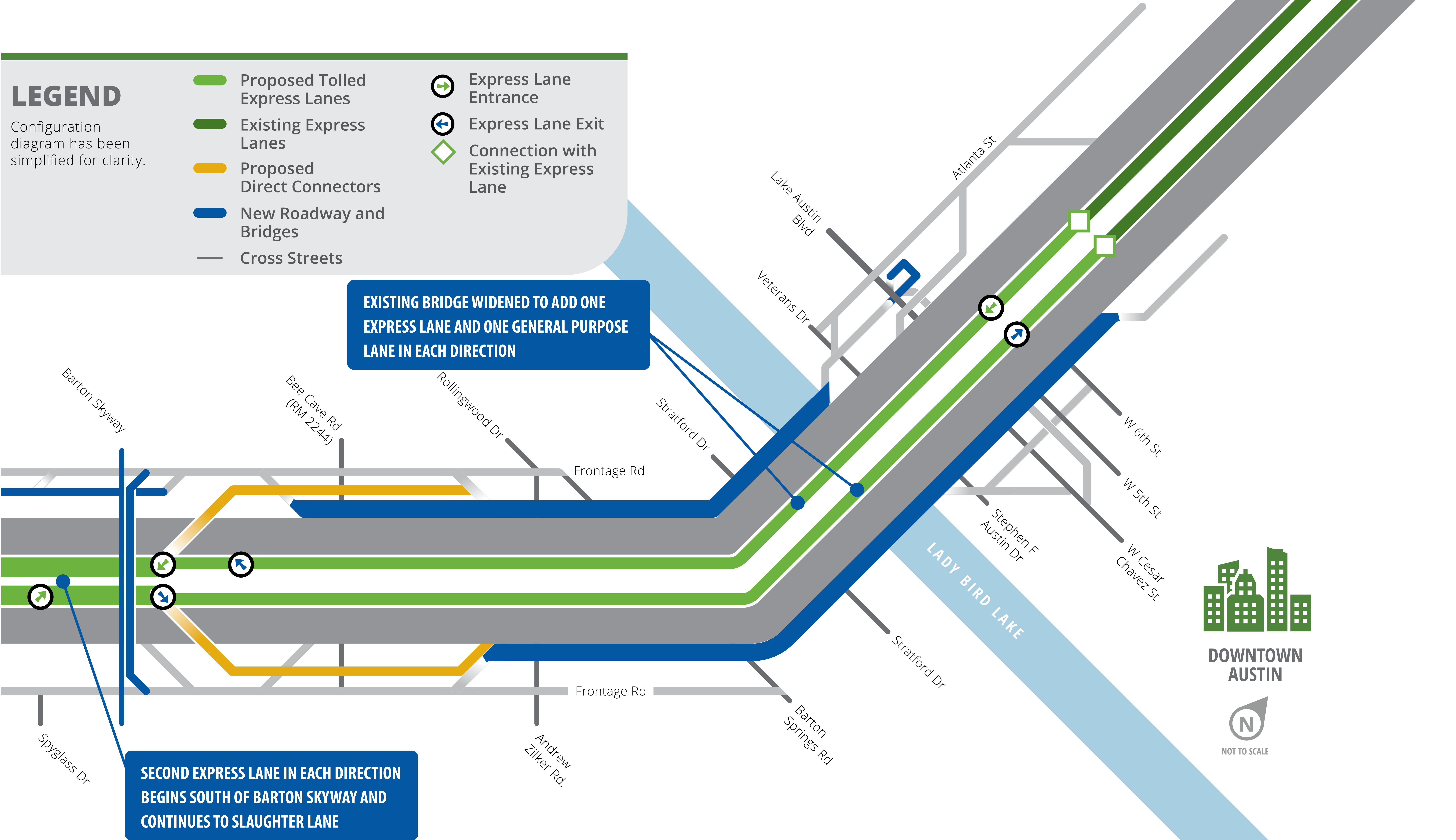

DOWNTOWN AUSTIN

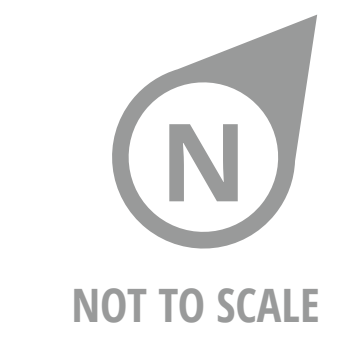

NOT TO SCALE



3: City of Austin Proposal

ACCESS TO AND FROM DOWNTOWN: ONE-LANE, ELEVATED DIRECT CONNECTOR RAMP IN EACH DIRECTION, TO AND FROM CESAR CHAVEZ STREET. TWO EXPRESS LANES IN EACH DIRECTION FROM CESAR CHAVEZ STREET TO US 290. ONE EXPRESS LANE IN EACH DIRECTION FROM US 290 TO SLAUGHTER LANE.

LEGEND

Configuration diagram has been simplified for clarity.

- Proposed Tolled Express Lanes
- Existing Express Lanes
- Proposed Direct Connectors
- Cross Streets
- New Roadway and Bridges
- Express Lane Entrance
- Express Lane Exit
- Connection with Existing Express Lane

